

ROLL-OFF CONTAINER AND COMPACTOR CONCRETE PAD LAYOUT (NOT TO SCALE)

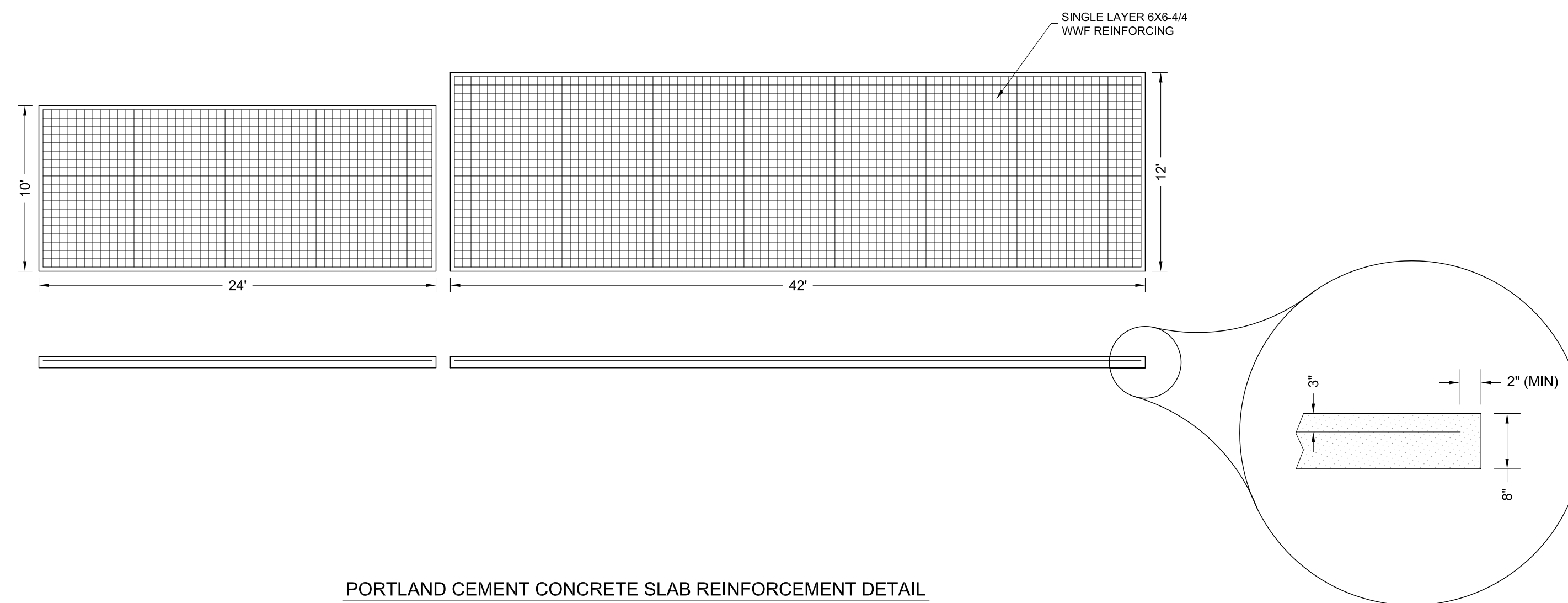

PORTLAND CEMENT CONCRETE SLAB REINFORCEMENT DETAIL (NOT TO SCALE)



CONCRETE BLOCK WALL ELEVATION (NOT TO SCALE)

ISOLATION JOINT DETAIL (NOT TO SCALE)

**R1-1**

**LEGEND - WHITE BACKGROUND - RED**

| AREA (SQ. FT.) | SIZE (INCHES) | CONN D.O.T. # | NO. POSTS | ALUM. THK |
|----------------|---------------|---------------|-----------|-----------|
| 5.19           | 30"           | 31-0552       | 1         | 0.080     |

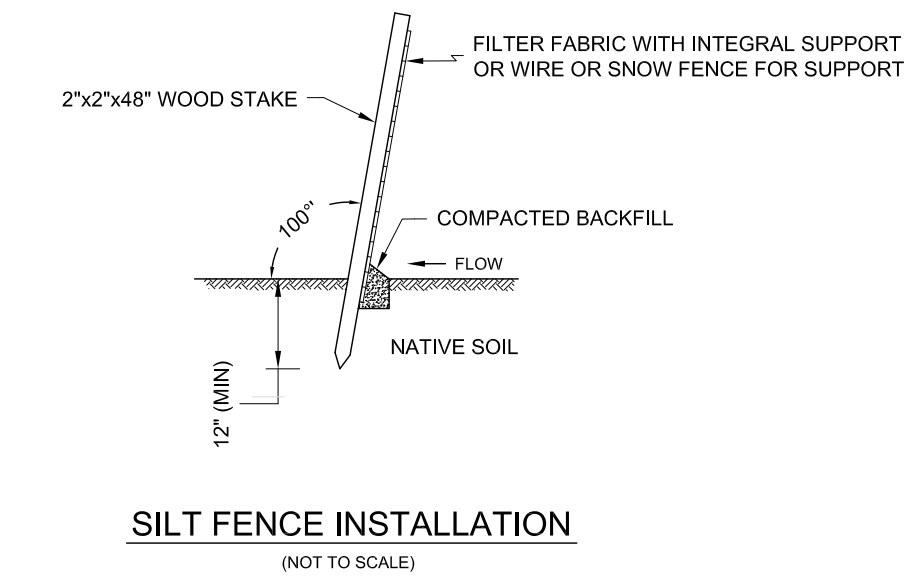

**R5-1**

**LEGEND - WHITE BACKGROUND - WHITE CIRCLE - RED**

| AREA (SQ. FT.) | SIZE (INCHES) | CONN D.O.T. # | NO. POSTS | ALUM. THK |
|----------------|---------------|---------------|-----------|-----------|
| 6.25           | 30"X30"       | 31-1119       | 1         | 0.080     |

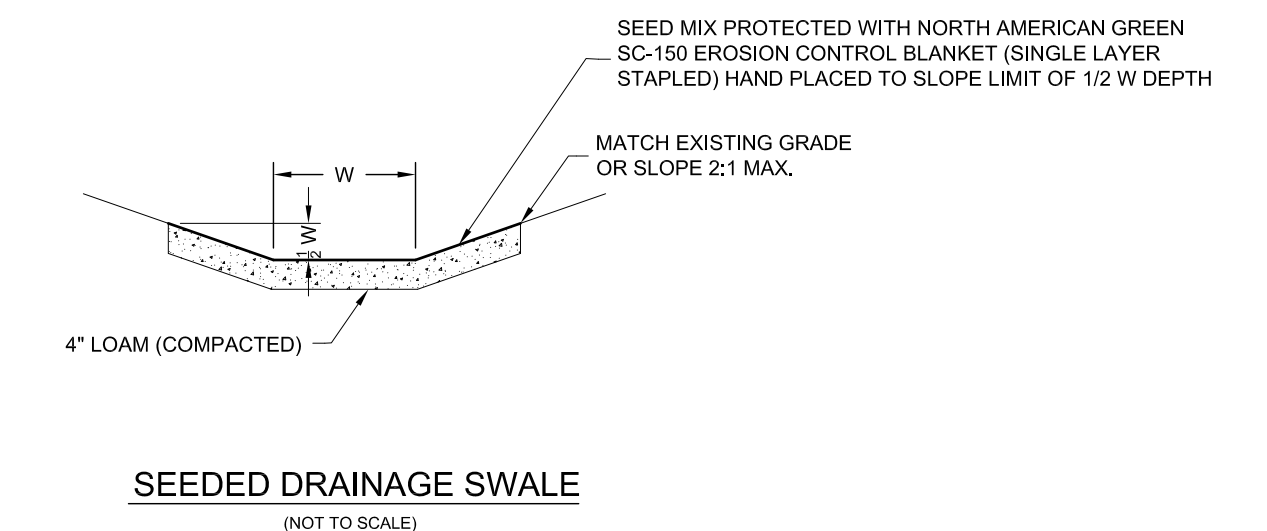

**R5-1**

| AREA (SQ. FT.) | SIZE (INCHES) | CONN D.O.T. # | NO. POSTS | ALUM. THK |
|----------------|---------------|---------------|-----------|-----------|
| 5.00           | 24"X30"       | 31-1790       | 1         | 0.080     |

**R6-1**

| AREA (SQ. FT.) | SIZE (INCHES) | CONN D.O.T. # | NO. POSTS | ALUM. THK |
|----------------|---------------|---------------|-----------|-----------|
| 3.00           | 36"X12"       | 31-1177R      | 1         | 0.080     |

**EXIT**

**BACKGROUND - YELLOW ARROW DIRECTION - RIGHT**

| AREA (SQ. FT.) | SIZE (INCHES) | CONN D.O.T. # | NO. POSTS | ALUM. THK |
|----------------|---------------|---------------|-----------|-----------|
| 5.00           | 24"X30"       | ----          | 1         | 0.080     |

SIGN DETAILS (NOT TO SCALE)

**GENERAL NOTES**

- THE CANTERBURY INLAND WETLANDS AND WATERCOURSES COMMISSION SHALL BE CONTACTED ONE (1) WEEK IN ADVANCE OF ANY PLANNED ACTIVITY ON THE SITE RELATING TO THE WORK PERMITTED UNDER THE WETLANDS APPLICATION. A PRE-CONSTRUCTION MEETING SHALL BE HELD WITH TOWN STAFF (PLANNER, ENGINEER, ETC.) PRIOR TO ANY CONSTRUCTION, TREE CLEARING, GRADING AND/OR EXCAVATION ACTIVITY AT THE SITE.
- ALL NEW PLANTINGS SHOWN ON THE PLANS SHALL BE MAINTAINED IN HEALTHY GROWING CONDITIONS AND SHALL BE MAINTAINED IN GOOD PHYSICAL AND AESTHETIC CONDITION THROUGHOUT THE LIFE OF THE USE. VEGETATION NOT SO MAINTAINED SHALL BE REPLACED WITH NEW MATERIALS NO LATER THAN THE BEGINNING OF THE FOLLOWING GROWING SEASON.
- ALL LOAM/TOPSOIL SHALL REMAIN ON THE SITE UNTIL A FINAL AS-BUILT SURVEY FOR THE SITE IS APPROVED BY STAFF WITH REGARDS TO COMPLIANCE WITH THE APPROVED PLANS.
- ANY DEVIATIONS FROM THE APPROVED PLANS SHALL BE SUBMITTED TO THE INLAND WETLANDS AND WATERCOURSES COMMISSION TO BE REVIEWED AND APPROVED BY THE TOWN PLANNER IN CONSULT WITH THE TOWN'S CONSULTING ENGINEER PRIOR TO THE CONSTRUCTION OF PROPOSED DEVIATIONS. STAFF MAY APPROVE SUCH DEVIATION(S) WHERE INLAND WETLANDS COMMISSION'S STAFF CONCLUDES, AT THEIR SOLE DISCRETION, THAT THE AESTHETICS AND/OR STRUCTURAL INTEGRITY OF THE APPROVED LAYOUT AND ASSOCIATED DRAINAGE DO NOT COMPROMISE THE ORIGINAL DESIGN.
- FINAL AS-BUILT PLANS SHALL BE SUBMITTED TO THE TOWN TO DETERMINE COMPLIANCE WITH THE APPROVED PLANS. AS-BUILT PLANS SHALL INCLUDE FINAL GRADES AND DRAINAGE. AS-BUILT PLANS SHALL BE REVIEWED FOR CONFORMANCE TO THE APPROVED SITE PLAN BEFORE ANY SURETY IS RELEASED. AS-BUILT PLANS MAY INCLUDE ADDITIONAL INFORMATION DEEMED NECESSARY BY STAFF TO DETERMINE COMPLIANCE WITH APPROVALS.
- SIGNS ARE TO BE MOUNTED ON BREAKAWAY TYPE METAL POSTS IN ACCORDANCE WITH CONDOT "TYPICAL METAL SIGN POSTS AND SIGN MOUNTING DETAILS (9)". BOTTOM OF SIGN SHALL BE NO LESS THAN 7' ABOVE GROUND UNLESS OTHERWISE APPROVED BY THE ENGINEER.

**EROSION & SEDIMENTATION CONTROL NOTES**

- THE PROPOSED ACTIVITY CONSISTS OF THE RENOVATION OF THE EXISTING SOLID WASTE TRANSFER STATION. WORK WILL INVOLVE MINOR EXCAVATION AND CREATION OF EMBANKMENTS. APPROXIMATELY 4,860 SQ FT OF WETLANDS WILL BE REMOVED AND RELOCATED TO A 5,442± SQ FT AREA ADJACENT TO EXISTING WETLANDS ON THE PROPERTY.
- PRIOR TO ANY CONSTRUCTION, EXCAVATION OR FILLING, ALL IMPROVEMENTS SHALL BE ACCURATELY STAKED IN THE FIELD.
- AFTER FIELD STAKING, ALL SOIL EROSION AND SEDIMENT CONTROL DEVICES, AS SHOWN ON THE PLAN AND AS DETAILED, SHALL BE INSTALLED. HAYBALES MAY BE USED IN LIEU OF SILT FENCING.
- ALL GRASS AND ORGANIC SOIL WITHIN THE AREAS OF DISTURBANCE SHALL BE REMOVED. ORGANIC SOIL SHALL BE STOCKPILED FOR LATER REUSE ON SLOPE AREAS.
- FINAL GRADES SHALL BE ACHIEVED AS QUICKLY AS POSSIBLE, AND IMMEDIATELY THEREAFTER, SIDESLOPES SHALL BE STABILIZED WITH 4" (MIN) OF TOPSOIL AND AN EROSION CONTROL BLANKET ON SLOPES STEEPER THAN 3:1. THE AREA SHALL BE SEED WITH THE FOLLOWING MIXTURE:

| SEED VARIETY   | LBS/ACRE | LBS/1000 SF |
|--|----------|-------------|
| CREeping RED FESCUE (PENNLAWN, WINTERGREEN)                        | 20.0     | 0.45        |
| RED TOP (STRECKER, COMMON)   | 2.0      | 0.05        |
| TALL FESCUE (KENTUCKY 31) OR SMOOTH BROMEGRASS (SARATOGA, LINCOLN) | 20.0     | 0.45        |
| TOTAL  | 42.0     | 0.95        |

- ALL SOIL EROSION AND SEDIMENT CONTROL MEASURES SHALL BE CONSTRUCTED IN ACCORDANCE WITH STANDARDS AND SPECIFICATIONS OF THE "2002 CONNECTICUT GUIDELINES FOR SOIL EROSION AND SEDIMENT CONTROL", CT DEP BULLETIN #34.
- ALL SOIL EROSION AND SEDIMENT CONTROL MEASURES SHALL BE MAINTAINED IN EFFECTIVE WORKING CONDITION THROUGHOUT THE CONSTRUCTION PERIOD AND SHALL BE INSPECTED WEEKLY OR AFTER ANY STORM EVENT OF 1/2" OR GREATER DEPTH OF PRECIPITATION. SEDIMENT SHALL BE PROMPTLY REMOVED FROM CONTROL STRUCTURES AND DISPOSED OF ON-SITE IN UPLAND AREAS OUTSIDE THE BUFFER ZONE OF THE WETLANDS. ANY SILT FENCE OR HAY BALES DAMAGED AS A RESULT OF A STORM EVENT OR CONSTRUCTION ACTIVITIES, SHALL BE IMMEDIATELY REPAIRED.
- THE TOWN OF CANTERBURY SHALL BE NOTIFIED PRIOR TO COMMENCEMENT OF CONSTRUCTION AND AT KEY POINT DURING CONSTRUCTION SO THAT INSPECTIONS OF SOIL EROSION AND SEDIMENT CONTROL MEASURES CAN BE SCHEDULED.
- THE RESPONSIBILITY FOR IMPLEMENTATION OF THIS PLAN SHALL REST WITH THE CONTRACTOR AWARDED THE PROJECT.

| REV. | DATE | REVISION DESCRIPTION | SHEET NO. |
|------|------|----------------------|-----------|
|      |      |                      |           |

THE INFORMATION INCLUDING ESTIMATED QUANTITIES OF WORK SHOWN ON THESE SHEETS IS BASED ON LIMITED INVESTIGATIONS BY NECCOG AND IS IN NO WAY WARRANTED TO INDICATE THE CONDITIONS OF ACTUAL QUANTITIES OF WORK WHICH WILL BE REQUIRED.

DESIGNER/DRAFTER:  
CHECKED BY:  
SCALE:  
**AS NOTED ON THE PLAN**

**NORTHEASTERN CONNECTICUT COUNCIL OF GOVERNMENTS**

ENGINEER:  
**SYL PAULEY, JR., P.E.**

APPROVED BY: \_\_\_\_\_ DATE: **JUNE 1, 2010**

PROJECT TITLE:  
**MUNICIPAL SOLID WASTE TRANSFER STATION RENOVATION PROJECT**

111 KINNE ROAD  
CANTERBURY, CONNECTICUT

TOWN:  
**CANTERBURY, CT**

DRAWING TITLE:  
**DETAILS & NOTES**

PROJECT NUMBER:  
DRAWING NUMBER:  
SHEET NUMBER:  
**DET-1**